



1 Block 1E_South Elevation
1 : 200

2 Block 1E_West Elevation
1 : 200

REV.	DATE:	DETAILS:	INITIALS:

KEY TO MATERIAL:
1. Yellow Brick, horizontal stretcher course, bedded in white mortar
2. Red Brick, horizontal stretcher course, bedded in white mortar
3. White Brick, horizontal stretcher course, bedded in white mortar
4. Aluminum windows with Aluminum External Framing, colour White (set in white brick) & graphite Grey (set in red and yellow brick)
5. Feature window vent openings to be provided in lacquered timber panel, within window fabrication
6. Handrails/ Balustrades in black painted mild steel circular section vertical rails, with flat plate black painted mild steel handrail
7. Base plinth in grey Limestone laid in 300mm/450mm horizontal coursing
8. Parapets, copings & flashings in naturally patinated zinc sheeting
9. Glass Handrail
10. Architectural banding, coping to top of brickwork & localized detail executed with natural white granite stone
11. Dark Grey Renson Linarte Facade

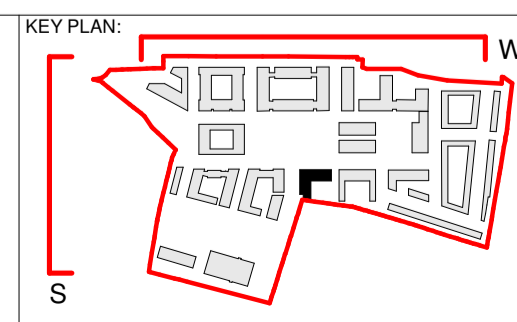

PLUS ARCHITECTURE		Chancery Lane, Dublin 8, Ireland. W: www.plusarchitecture.ie T: 353 (0) 1 521 3378	
PROJECT: North London Business Park	PROJECT: 211	DATE: 21/06/2021	REVISION NO.:
CLIENT: The Comer Group	DRAWING NO.: 211_1E_04_02	DRAWN BY: JG	SCALE AT A1.: 1 : 200
TITLE: Block 1E_South Elevation & West Elevation	CHECKED BY: DT	SCALE AT A3.:	
ISSUE TYPE: Planning			

Copyright of this drawing is vested in the architect and it must not be copied or reproduced without consent. Figure dimensions only are to be taken from this drawing. All annotations must not only be responsible for being and checking all dimensions against their work. PLUS Architecture are to be advised of any variation between drawings and site conditions. DO NOT SCALE OFF THIS DRAWING. IF IN DOUBT ASK.