

Project update

Work successfully started on the reconstruction of Hampden Way on 29 July 2024. We would like to thank all residents impacted by these works for your ongoing patience and cooperation. Furthermore, thank you to those residents within the work zone of Phase One for ensuring your vehicles were moved.

The reconstruction is currently running to schedule, with Phase One scheduled for completion on 14 September 2024. You can find details on Phase Two on the back page of this newsletter.

Since work commenced, we have:

- Removed 750 tonnes of tarmac, concrete and clay, which has been sent to a certified waste recycling facility.
- Working in collaboration with Affinity Water, we have re-surveyed the carriageway to locate all underground utilities and confirm their depth and location.
- To prevent any unnecessary damage to the shallow utilities, several trial hole excavations have been carried out to investigate the soil and groundwater for the project.
- Completed site safety inductions for over 40 subcontractors who are due to work on the project.
- To prevent any unnecessary vibration, the carriageway has been saw cut full depth from kerb to kerb.
- Our Community Engagement Manager worked with some local residents, helping them to create personalised plans of how to safely get around during the works.
- The Community Engagement Manager also met with Hampden Way Nursery and we agreed to assist them in removing a large shed. TKJV are currently in the process of co-ordinating a day with the nursery to remove the shed.



You Said, We did

- We received reports of mopeds and motorbikes using the pedestrian access path during the road closure. To prevent this continuing we narrowed the path and added additional signage.
- Following feedback from residents, we placed additional signage about the road closure and diversion route on surrounding streets.

Get in touch with the Hampden Way project team using the contact details on the back page of this newsletter.



Phase Two

Phase Two of the resurfacing works will start on 16 September 2024, and is scheduled to be complete on 9 November 2024.

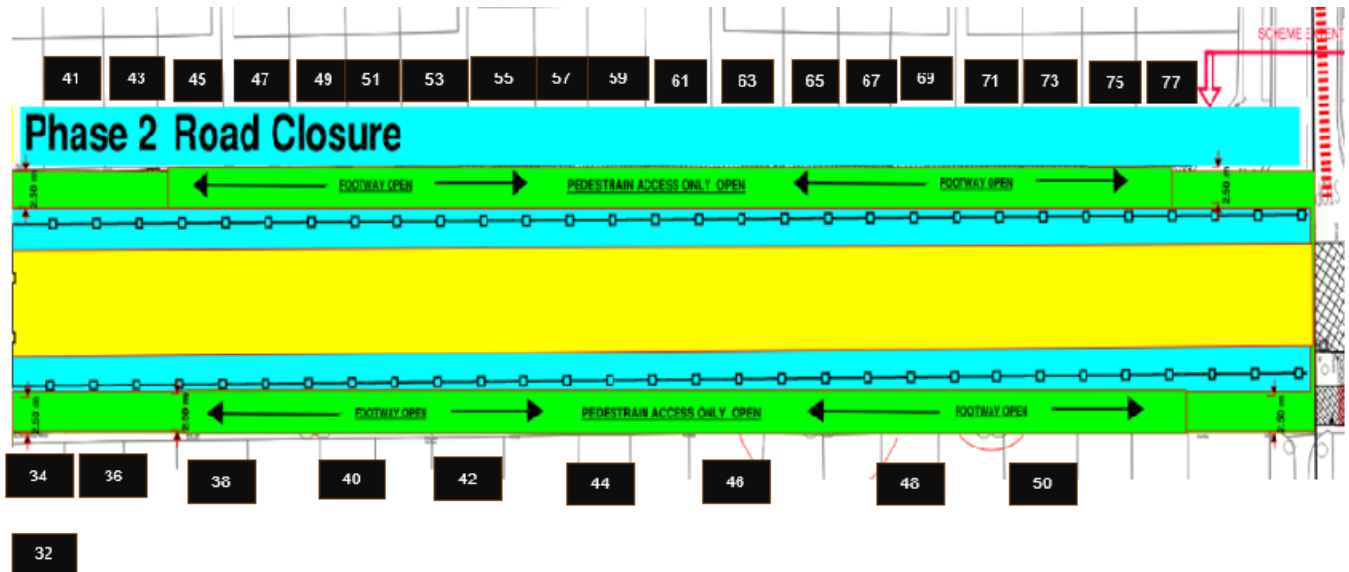

We kindly ask that all those who live between number 32 and 77 to move their vehicles before the start date of Phase Two. **You will be unable to move your vehicle once excavation has commenced.** There are no parking restrictions in the surrounding roads.

For further information and to read our FAQs please visit our dedicated scheme website: barnet.gov.uk/hampden-way-reconstruction

Contact us:

You can contact our dedicated Hampden Way project team by:

- emailing on danielle.oconnell@kier.co.uk
- or telephoning / texting **07749 576628**
- visiting our Community Engagement Manager on site Monday to Thursday, from 9am to 5pm: Osidge Lane Car Park, 130 Osidge Lane, Barnet, EN4 8JT.

