

1 Block 1F_North Elevation
1 : 200

2 Block 1F_East Elevation
1 : 200

REV.	DATE:	DETAILS:	INITIALS:

- KEY TO MATERIAL:
1. Yellow Brick, horizontal stretcher course, bedded in white mortar
 2. Red Brick, horizontal stretcher course, bedded in white mortar
 3. White Brick, horizontal stretcher course, bedded in white mortar
 4. Aluminum windows with Aluminum External Framing, colour White (set in white brick) & graphite Grey (set in red and yellow brick)
 5. Feature window vent openings to be provided in lacquered timber panel, within window fabrication
 6. Handrails/ Balustrades in black painted mild steel circular section vertical rails, with flat plate black painted mild steel handrail
 7. Base plinth in grey Limestone laid in 300mm/ 450mm horizontal coursing
 8. Parapets, copings & flashings in naturally patinated zinc sheeting
 9. Glass Handrail
 10. Architectural banding, coping to top of brickwork & localized detail executed with natural white granite stone
 11. Dark Grey Renson Linarte Facade

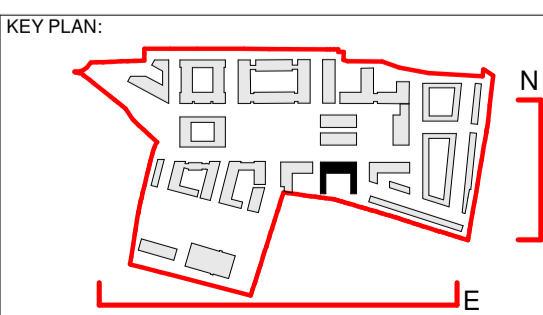

		Chancery Lane, Dublin 8, Ireland. W: www.plusarchitecture.ie T: 353 (0) 1 521 3378	
PROJECT:	North London Business Park	PROJECT:	211
CLIENT:	The Comer Group	DRAWING NO.:	211_1F_04_01
TITLE:	Block 1F_North & East Elevation	DRAWN BY.:	JG
ISSUE TYPE:	Planning	CHECKED BY.:	DT
		DATE:	21/06/2021
		REVISION NO.:	
		SCALE AT A1.:	1 : 200
		SCALE AT A3.:	

Copyright of this drawing is vested in the architect and it may not be copied or reproduced without consent. Figure dimensions only are to be taken from this drawing. All annotations must not only be responsible for being and checking all dimensions relative their work. PLUS Architecture are to be advised of any variation between drawings and the construction. DO NOT SCALE OFF THIS DRAWING. ... AT ALL COSTS!